

PERMIT

CITY OF NAPOLEON - BUILDING DEPARTMENT
 255 West Riverview Avenue, Napoleon, Ohio 43545 - 419-592-4010

Permit No. 827-77 Issued 9-19-77
date

Job Location 526
~~534~~ W. Main St.
address

Pt Lot 6 Phillip's & Staffords OL 1
sub-div or legal discript

Issued By Ronald D. Sommerberg
building official

Owner Lowell Rausch 592-5556
name tel.

Address 534 W. Main St.

Agent Rausch Lumber Co. 592-3866
builder-eng.-etc. tel.

Address 118 W Front St.

Description of Use New Dwelling

Residential XXX(1)
no. dwelling units

Commercial _____ Industrial _____

New XX Add'n. _____ Alter _____ Remodel _____

Mixed Occupancy _____

Change of Occupancy _____

Estimated Cost \$45,000.00

FEES	BASE	PLUS	TOTAL
<input checked="" type="checkbox"/> BUILDING	\$79.50	-0-	\$79.50
<input checked="" type="checkbox"/> ELECTRICAL	\$30.55	-0-	\$30.55
<input checked="" type="checkbox"/> PLUMBING	\$3.00	\$9.00	\$12.00
<input checked="" type="checkbox"/> MECHANICAL	\$6.00	\$3.00	\$9.00
<input type="checkbox"/> DEMOLITION			
<input checked="" type="checkbox"/> ZONING	----	----	---
<input type="checkbox"/> SIGN			
WATER TAP	\$225.00	-0-	\$225.00
SEWER TAP	\$60.00	-0-	\$60.00
TEMP. ELECT.	\$10.00	-0-	\$10.00
ADDITIONAL PLAN REVIEW	Struct. _____ hrs _____ Elect. _____ hrs _____		
TOTAL FEES.....			\$426.05
LESS MIN. FEES PAID _____ <small>date</small>			-0-
BALANCE DUE.....			\$426.05

ZONING INFORMATION

district "B"	lot dimensions 85'8" x 120'	area 10280.0 sq'	front yd 28'	side yds 12.30K	rear yd 54.6 OK
max hgt 35'	no pkg spaces 2 req'd	no ldg spaces n/a	max cover 45% OK	petition or appeal req'd ---	date appr ---

WORK INFORMATION:

Size: Length 65' Width 37'4" Stories 1 Ground Floor Area 2262.06 sq'

Height _____ Building Volume (for demo. permit) _____ cu. ft.

Electrical: Installing service entrance, wiring, & devices.
brief description

Plumbing: Installing water & Drainage lines.
brief description

Mechanical: Installing heat pump & ductwork.
brief description

Sign: _____ Dimensions _____ Sign Area _____
type

Additional Information: SEE ATTACHED ADDENDUM:

Date 9/20/77 Applicant Signature Lowell Rausch
owner-agent

INSPECTION RECORD

UNDERGROUND			ROUGH-IN						FINAL		
Type	Date	By	Type	Date	By	Type	Date	By	Type	Date	By
PLUMBING	Building Drains	12/19/77	Drainage, Waste & Vent Piping	12/29/77		Indirect Waste			Drainage, Waste & Vent Piping	5/23/78	
	Water Piping								Backflow Prevention	(()
	Building Sewer	1/19/78	Water Piping			Condensate Lines			Water Heater		
	Sewer Connection	" "							FINAL APPROVAL	((
MECHANICAL	Refrigerant Piping		Refrigerant Piping			Chimney(s)			Grease Exhaust System		
			Duct Furnace(s)			Fire Dampers			Air Cond. Unit(s)		
	Ducts/Plenums		Ducts/Plenums			<input type="checkbox"/> Radiant Htr(s) <input type="checkbox"/> Unit Htr(s)			Refrigeration Equipment		
			Duct Insulation			Pool Heater			Furnace(s)		
		Combustion Products Vents			Ventilation <input type="checkbox"/> Supply <input type="checkbox"/> Exhst.			FINAL APPROVAL			
ELECTRICAL	Conduits & or Cable		Conduits/ Cable			<input type="checkbox"/> Range <input type="checkbox"/> Dryer			Temp Service Temp Lighting		
	Grounding & or Bonding		Rough Wiring	12/15/77		<input type="checkbox"/> Generator(s) <input type="checkbox"/> Motors			Fixtures Lampholders		
	Floor Ducts Raceways		Service Panel Switchboard	" "	" "	<input type="checkbox"/> Water Htr <input type="checkbox"/> Welder			Signs		
	Service Conduit		Busways Ducts			<input type="checkbox"/> Heaters <input type="checkbox"/> Heat Cable			Electric Mtr. Clearance		
	Temporary Power Pole		Subpanels			<input type="checkbox"/> Duct Htr(s) <input type="checkbox"/> Furnace(s)			FINAL APPROVAL	6-29 78	5-25 78 WAT
BUILDING	Location, Set-backs, Esmt(s)	1/19/78	Exterior Wall Construction			Roof Covering Roof Drainage			Smoke Detector		
	Excavation	1/29/78				Exterior Lath			Demolition (sewer cap)		
	Footings & Reinforcing					<input type="checkbox"/> Interior Lath <input type="checkbox"/> Wallboard					
	Floor Slab		Interior Wall Construction			Fire Wall(s)			Building or Structure		
	Foundation Walls		Columns & Supports			Fireplace Chimney					
	Sub-soil Drain		Crawl Space <input type="checkbox"/> Vent <input type="checkbox"/> Access			Attic <input type="checkbox"/> Vent <input type="checkbox"/> Access					
	Piles		Floor System(s)						FINAL APPROVAL BLDG. DEPT.	1/24/78	
		Roof System			Special Insp Reports Rec'd			Certificate of Occupancy Issued	1/25/78		
ADDITIONAL	INSPECTIONS, CORRECTIONS, ETC.					INSPECTIONS, CORRECTIONS, ETC.					
	%					* 142 issued 7-5-78					

CITY OF NAPOLEON

Engineering Department

ELECTRICAL INSPECTION FIELD REPORT

255 Riverview Avenue Napoleon, Ohio 43545

(Please Print or Type)

Date 5-25-78

Permit No. 827-77

Type of Inspection ELECTRICAL

Type of Occupancy 1 FAMILY

Project Name RAUSCH

Address 520 W MAIN St.

City NAPOLEON State OH

Approved

Violation X

Electrical Contractor

Remarks:

Code Reference 75NEC

① - DISCONNECT AT FAN COIL UNIT.

ART-440-14

② - N.M. CABLE INSTALLED IN WET & DAMP LOCATION, TO FAN COIL UNIT.

ART-336-3

Complied 6-29-78
NHT

Compliance Time AT ONCE

Inspectors Signature M. Howel

Copies To: RAUSCH LUMBER Co.

RESIDENTIAL PLAN CORRECTION SHEET

CITY OF NAPOLEON, Building Dept.
 255 West Riverview Avenue
 Napoleon, Ohio 43545
 (419) 592-4010

ADDENDUM to Permit No. 827-77
 Owner L. RAUSCH
 Location 526 W. MAIN

Please note the Items checked below and incorporate them into your plans as indicated: Permit not yet issued
 Correct Plans and Re-Submit. Permit Issued Incorporate the Items during construction.

GENERAL	
<input checked="" type="checkbox"/> Provide 1 approved smoke detector.	<input checked="" type="checkbox"/> Show size of members supporting porch roof.
<input checked="" type="checkbox"/> Provide 1 hour fire wall and/or ceiling between garage and dwelling.	<input type="checkbox"/> Provide double top plate.
<input checked="" type="checkbox"/> Provide (Class B) 1 hour fire rated door from garage to dwelling.	<input checked="" type="checkbox"/> Provide design data for pre-fab. wood truss/members.
<input type="checkbox"/> Submit fully dimensioned plot plan.	<input checked="" type="checkbox"/> Ceiling joists undersized in <u>GATHERING ROOM</u> <u>BEDROOM # 3 AREA</u>
<input type="checkbox"/> Provide 1-3'0" x 6'8" exit door.	<input type="checkbox"/> Roof rafters undersized in.....
<input type="checkbox"/> Provide min. 22" x 30" attic access.	PLUMBING AND MECHANICAL:
<input checked="" type="checkbox"/> Provide min. 18" x 24" crawl space access opening.	<input checked="" type="checkbox"/> Terminate all exhaust systems to outside air.
LIGHT AND VENTILATION:	<input checked="" type="checkbox"/> Insulate ducts in unheated areas.
<input type="checkbox"/> Provide mechanical exhaust or window in bathroom.....	<input checked="" type="checkbox"/> Provide back flow device on all hose bibs.
<input checked="" type="checkbox"/> Provide Min. <u>958</u> sq. in. net free area attic ventilation.	ELECTRICAL:
<input checked="" type="checkbox"/> Provide min. <u>716</u> sq. in. net free area crawl space ventilation.	<input type="checkbox"/> Show location of service entrance and service equipment panel.
FOUNDATION:	<input checked="" type="checkbox"/> G.F.C.I. req'd. on Temp. Electric.
<input type="checkbox"/> Min. depth of foundation below finished grade 30".	<input checked="" type="checkbox"/> Outdoor and bathroom receptacles shall be protected by G.F.C.I.
<input type="checkbox"/> Min. size of footer....." x"	METAL VENEERS:
<input checked="" type="checkbox"/> Provide anchor bolts 1/2" @ 8' o.c. 1' from each corner. Embedded 8" concrete and 15" in masonry.	<input type="checkbox"/> Contact City Utilities Dept. to remove conductors and/or meter.
<input type="checkbox"/> Show size of basement columns.	<input type="checkbox"/> Provide 18" x 18" x 3/4" wood backer for meter base.
FRAMING:	<input checked="" type="checkbox"/> Provide approved system of grounding and bonding.
<input type="checkbox"/> Show size of wood girder in.....	MISCELLANEOUS:
<input type="checkbox"/> Provide design data for structural member in.....	<input checked="" type="checkbox"/> Provide backwater valve in sub-soil drain tile.
<input type="checkbox"/> Floor joists under sized in.....	<input type="checkbox"/> Provide approved sheathing and flashing behind masonry veneer.
<input checked="" type="checkbox"/> Provide double joists under parallel partitions.	<input type="checkbox"/> Provide 15# felt underlayment on roof.
<input checked="" type="checkbox"/> Provide 1" x 4" let in corner bracing or approved sheathing.	<input checked="" type="checkbox"/> Provide adequate fireplace hearth extensions
<input type="checkbox"/> Show size of headers for openings over 4' wide.	<input type="checkbox"/> Install factory built fireplaces/stoves according to manufacturers recommendations.
	<input checked="" type="checkbox"/> Terminate chimney 3' above roof or 2' above highest point of building within 10' of chimney.

ADDITIONAL CORRECTIONS: _____

The approval of plans and specifications does not permit the violation of any section of the Building Code, or other City Ordinance or State Law. This addendum is attached to Permit No. 827-77 and made a part thereof.

Date Approved or Disapproved 9-19-77

Checked By Ronald D. Sonnenberg
 Plan Examiner

Date Rechecked and Approved _____

Checked By _____

CITY OF INDIANAPOLIS
BUILDING DEPARTMENT
APPLICATION FOR CONSTRUCTION PERMIT
PLEASE PRINT OR TYPE

827-77

#79.50

The undersigned hereby makes application for the construction, installation, replacement or a rearrangement of building structure, including to do all such work in strict accordance with the City of Indianapolis Building Code for 1, 2 and 3 Family Buildings.

Owner's name LOWELL RAUSCH Address 534 W. MAIN ST.
Builder's name RAUSCH LBR. CO. Address NAPOLEON, O. Tel. 592-3866

LOT INFORMATION: (Not required for roofing or plumbing jobs.)

Location of Project W. MAIN ST. Lot # PART # 6
Subdivision PHILLIPS & STAFFORD Lot Area 10284 Sq. Ft.
Yard Set Back: Front 28'0" Rear 54'8" Left Side 8'4"
Right Side 12'4" Zoning District B

BUILDING INFORMATION:

Single Double _____ Multiple _____ New Addition
Addition _____ Remodel _____ Attached Garage _____
Detached Garage _____ Accessory Building _____ Replacement _____

Brief Description of Work: _____

Size: Length 65'0" Width 37'4" Number of Stories 1
Floor Area: 1st Floor 1424 Sq. Ft. 2nd Floor _____ Sq. Ft.
3rd Floor _____ Sq. Ft. Basement _____ Sq. Ft.
Unfinished Area: _____ Garage 572

Foundation: Piers Full Basement _____ Part Basement _____
Concrete _____ Brick 8" Size _____

Walls: Frame Block _____ Brick _____ Other _____
Specific Type of Wall or Siding ALUM.

APPLICATION FOR PERMIT SHALL BE ACCOMPANIED BY THE COMPLETE SETS OF PLANS INCLUDING: ELEVATIONS, FLOOR PLANS, CROSS SECTIONS AND PLOT PLAN. IF ADDITIONS OR REMODELING, SHOW ALL EXISTING STRUCTURES AND THEIR SIZE AND LOCATION. ALL PLANS SHALL BE DRAWN TO SCALE. 47,000.00

ESTIMATED COST OF DESCRIBED PROJECT: 45,000.00

DATE 4/13/77 Applicant's Signature Lowell Rausch

CITY OF NAPOLEON
BUILDING INSPECTION DEPARTMENT
APPLICATION FOR HEATING PERMIT
(PLEASE PRINT OR TYPE)

6.00
+ 3.00

9.00

The undersigned hereby makes application for the installation, replacement or alteration of a heating system or device as herein specified, agreeing to do all such work in strict accordance with the City of Napoleon's adopted Mechanical Code for 1, 2 and 3 Family Buildings.

Owner's Name LOWELL RAUSCH Address 534 W. MAIN ST.

Contractor's Name STANDARD PLBC. Address NAPOLEON, O. Tel. 592-5406

BUILDING INFORMATION:

Single Family Double Family _____ Multiple _____ New Construction
Addition _____ Remodel _____ Replacement _____ No. of Stories 1

DESCRIPTION OF WORK

Heating System - Warm Air Hot Water _____ Steam _____ Electric _____

Unit Heaters _____ Unit Gas Heaters _____ Other _____

Type - Gravity _____ Forced Radiant _____

No. of Thermostatical Heating Zone 1

Hot Water - One Pipe _____ Two Pipe _____ Series Loop _____

Electric Heat - No. of Circuits _____ Other Heat Pump

Total Heat Loss of Area to be Heated 51,000 BTU

Rated Capacity of Furnace/Boiler 56,000 BTU

No. of Furnaces 1 No. of Hot Air Runs 13

No. of Hot Water Radiators _____ Type of Fuel Electric

Heating Units Located: Crawl Space _____ Floor Level Suspended _____

Roof or Exposed to Outside Air _____ Attic _____ Other _____

APPLICATION FOR PERMIT SHALL BE ACCOMPANIED BY TWO COMPLETE SETS OF PLANS INCLUDING: LOCATION OF FURNACE OR UNIT HEATERS AND SIZE AND LOCATION OF FEEDER DUCTS AND RETURN AIR DUCTS. ALL PLANS SHALL BE DRAWN TO SCALE.

ESTIMATED COST OF COMPLETED PROJECT: _____

DATE 9/13/77 APPLICANT'S SIGNATURE Lowell Rausch
OWNER-CONTRACTOR-AGENT

13
+ 6.00
+ 3.00

9.00

Date: 9-19-77

Distribution Superintendent
Building Inspector - Building Department

the installation of 200 V.G. AMP. electrical
located REAR OF PROPOSED DWELLING

address: 526 W. MAIN ST.

Not Approved

all holes

9-20-77

Date

vice is to be at West-end of
ground would be preferred

CITY OF NAPOLEON
BUILDING INSPECTION DEPARTMENT
APPLICATION FOR ELECTRICAL PERMIT
(PLEASE PRINT OR TYPE)

\$ 30.55

The undersigned hereby makes application for the installation, replacement, or alteration of electrical equipment as herein specified, agreeing to do all such work in strict accordance with the City of Napoleon's adopted Electrical Code for 1, 2 and 3 Family Buildings.

Lowell Rausch

Owner's Name Rausch Lumber Company Address Front Street Napoleon, Ohio

Contractor's Name Jim Speiser Electric Address Napoleon, Ohio Tel. 599-1846

LOT INFORMATION:

Location of Project West Main Street Napoleon Zoning District B

BUILDING INFORMATION:

Single Family Double Family _____ Multiple Family _____

New Construction Existing _____ Addition _____

Replacement _____ Remodel _____ Service Change _____

Size: Total Square Foot Per Floor _____ No. of Stories 1

DESCRIPTION OF WORK

Size of Service 200 AMP. Service Change Only No (Yes or No)

Total Number of New Circuits 42 Total Number of New Circuits Excluding Appliance Circuits 33

APPLIANCE CIRCUITS: (indicate quantity)

Electric Range Range Hood Clothes Dryer Dishwasher

Air Conditioner Attic Fan Blower _____ Room Exhaust Fan 2

Disposal Hot Water Heater 1 Electric Oven _____

Require Temporary Electric Yes No (Yes or No)

Note: G.F.I.C. required for all temporary electric with approved ground rod at service.

APPLICATION FOR PERMIT SHALL BE ACCOMPANIED BY TWO COMPLETE SETS OF PLANS INCLUDING: ELECTRICAL LAY-OUT AND RISER DIAGRAM.

ESTIMATED COST OF COMPLETED PROJECT:

DATE 9/7/77

APPLICANT'S SIGNATURE

JIM SPEISER ELECTRIC

XXXXX-CONTRACTOR-XXXXX

42
9
33
32
23
9.00
1.00
6.75
13.80
30.55

ation Superintendent

Date: 9-19-77

Inspector - Building Department

proposed installation of 3/4" water tap
PROPOSED HOUSE

Address: 526 W. MAIN ST. Lot # 6

Not Approved

9-20-77
Date

Service - 4" C.I. main

CITY OF NAPOLEON
BUILDING INSPECTION DEPARTMENT
APPLICATION FOR PLUMBING PERMIT
(PLEASE PRINT OR TYPE)

$\frac{3}{9} / 12.00$

The undersigned hereby makes application for the installation, replacement or alteration of plumbing system or device as herein specified, agreeing to do all such work in strict accordance with the City of Napoleon's adopted Plumbing Code for 1, 2 and 3 Family Buildings.

Owner's Name LOWELL RAUSCH Address 534 W. MAIN ST.

Contractor's Name STANDARD PLBG. Address NAPOLEON, O. Tel. 592-5906

BUILDING INFORMATION:

Single Family Double Family Multiple Family New Construction
Addition Remodel Replacement No. of Stories 1

DESCRIPTION OF WORK

Drainage Pipe of: Cast Iron Copper Other PVC

Size of Main Building Drain: 4" Other

Size of Main Vent Stack: 3" 4" Other

Require Water Tap: YES (Yes or No) Require Sewer Tap: YES (Yes or No)

Size and Type of Water Tap 3/4" COPPER

Size and Type of Sewer Tap 6" VIT. Type of Joints PREM.

No. of Water Closets 2 No. of Sump Pumps

No. of Bathtubs 1 No. of Lavatories 2

No. of Kitchen Sinks 1 No. of Automatic Washers 1

No. of Disposals 1 No. of Hot Water Heaters 1

No. of Dishwashers 1 No. of Shower Receptors 1

No. of Floor Drains Other (specify)

Storm Drainage Outlet to: Storm Sewer Other

APPLICATION FOR PERMIT SHALL BE ACCOMPANIED BY TWO COMPLETE SETS OF A DRAINAGE ISOMETRIC, WITH ALL PIPES AND TRAPS PROPERLY SIZED. MUST INDICATE TOTAL DRAINAGE FIXTURE UNIT VALUE (dfu).

ESTIMATED COST OF COMPLETED PROJECT:

DATE 9/13/77 APPLICANT'S SIGNATURE Lowell Rausch

OWNER-CONTRACTOR-AGENT

$\frac{3}{9} / 12$

APPLICATION FOR PERMIT TO TAP SEWER

(Print or Type)

Owner Lowell Rausch
Address 534 W. Main St.
Contractor Rausch Lumber Co.
Address 118 W. Front St. Tel. 592-3866

NO. 749
BLDG. PERMIT 827-77
PERMIT FEE \$ 50.00
DATE PAID 9-20-77
for office use only

LOCATION OF CONNECTION

Street and No. 526 W. Main St. Sanitary XXX Storm _____
Lot No. 6 Subdivision Phillips & Staffords Outlot #1 Size of Tap 6"
Size and Type of Sewer 6" Vit clay Pre. joint. ALL WORK MUST BE INSPECTED

I certify that the sewer will be used only as indicated and no other Drainage will be connected.

Date _____ Signature _____ owner-builder-agent
do not write below this line

INSPECTION RECORD

Date Inspected 10/19/77 Size and Type of Sewer 6" VIT CLAY PRE JOINT
Location 526 W. MAIN HOUSE Depth 4 1/2' @ TEST "T" Type of Test 5 PSI AIR
Inspected and Approved By: ROBERT LUDEMAN Inspector Date 10/19/77
Additional Information _____

Send copy to: LOWELL RAUSCH 534 W. MAIN MADISON

SKETCH OF INSTALLATION

NOT TO SCALE

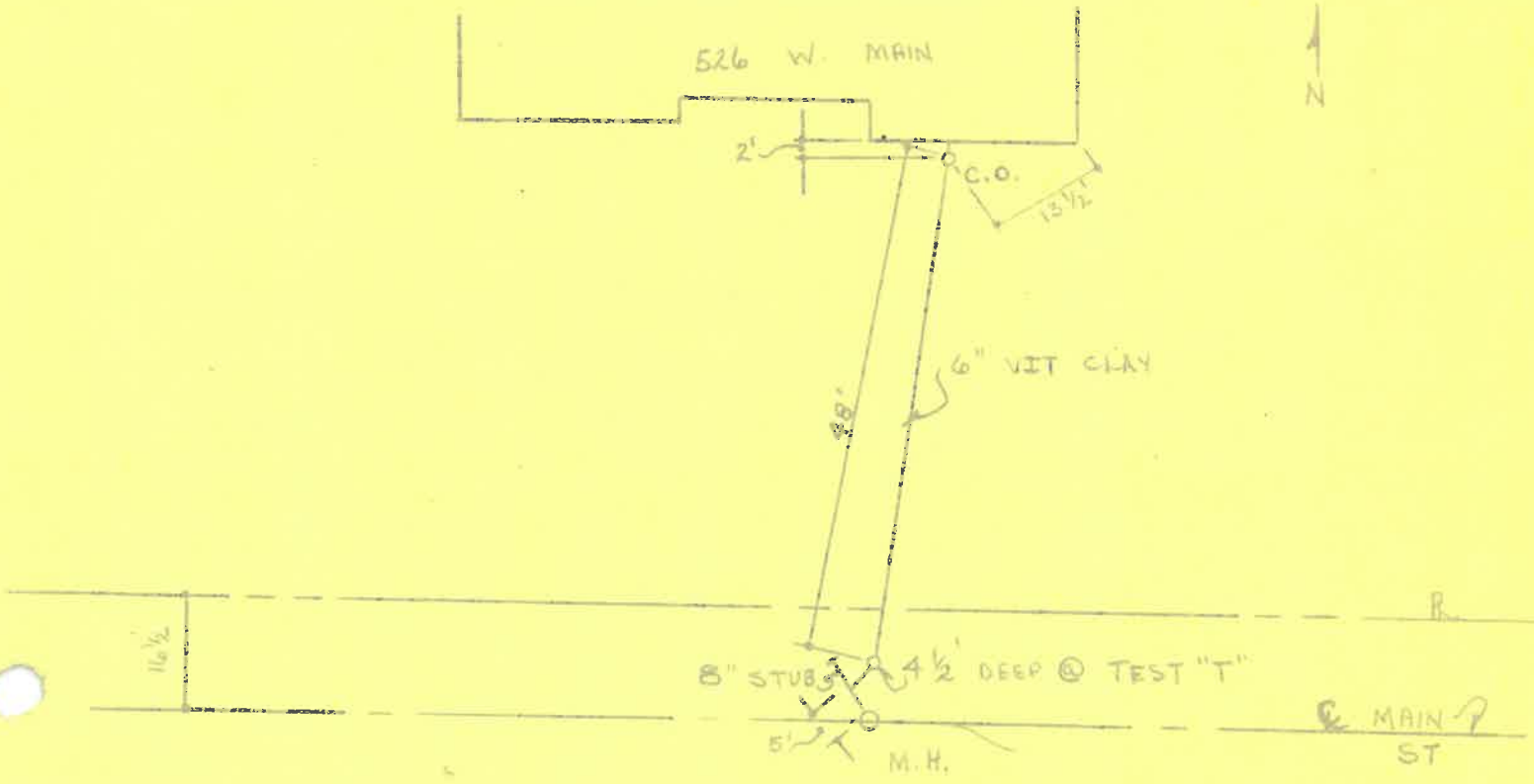

No.142.....

CERTIFICATE OF OCCUPANCY
THE CITY OF NAPOLEON

ENGINEERING DEPARTMENT
DIVISION OF INSPECTION

This is to certify that the Building or Land as herein described complies with all the building and health laws and ordinances and with the provisions of the Zoning Ordinance.

Location of Occupancy 526 W. Main St. Occupancy Single Family Home

Owner of Property Lowell Rausch Address 534 W. Main Napoleon, OH 43545

Issued to Rausch Lumber Co. Address 118 W. Front St Napoleon, OH 43545

Zoning "B" Residential District Bldg. Permit No. 827-77

Substantial qualifications of occupancy

This certificate is issued by the City Building Inspector, as provided by law, and is to certify that construction is completed substantially in conformity with the approved plans and permission is hereby granted to occupy such building in compliance with such legal use and occupancy as authorized under the provisions of the ordinances of the City of Napoleon.

Issued this 5th day of July 19 78

This is a valuable record for owner or lessee and should be so preserved. Signed City Building Inspector

